



ROBOX

ROBOX™ Navigation System
 Temi's human-robot interaction and autonomous navigation

2D Mapping
 Obstacle avoidance
 Path planning

CPU
 ARM Hexa Core
 LINUX OS

SENSORS
 360 degrees LIDAR
 2 depth cameras
 RGB camera
 IMU sensor
 6 Time of Flight linear sensors

Fully-Autonomous Navigation with accuracy of 5cm/2Inches
 Navigation and Human Follow mode without the need of any external device.
 Real-time sensor fusion and data analysis ensures safe

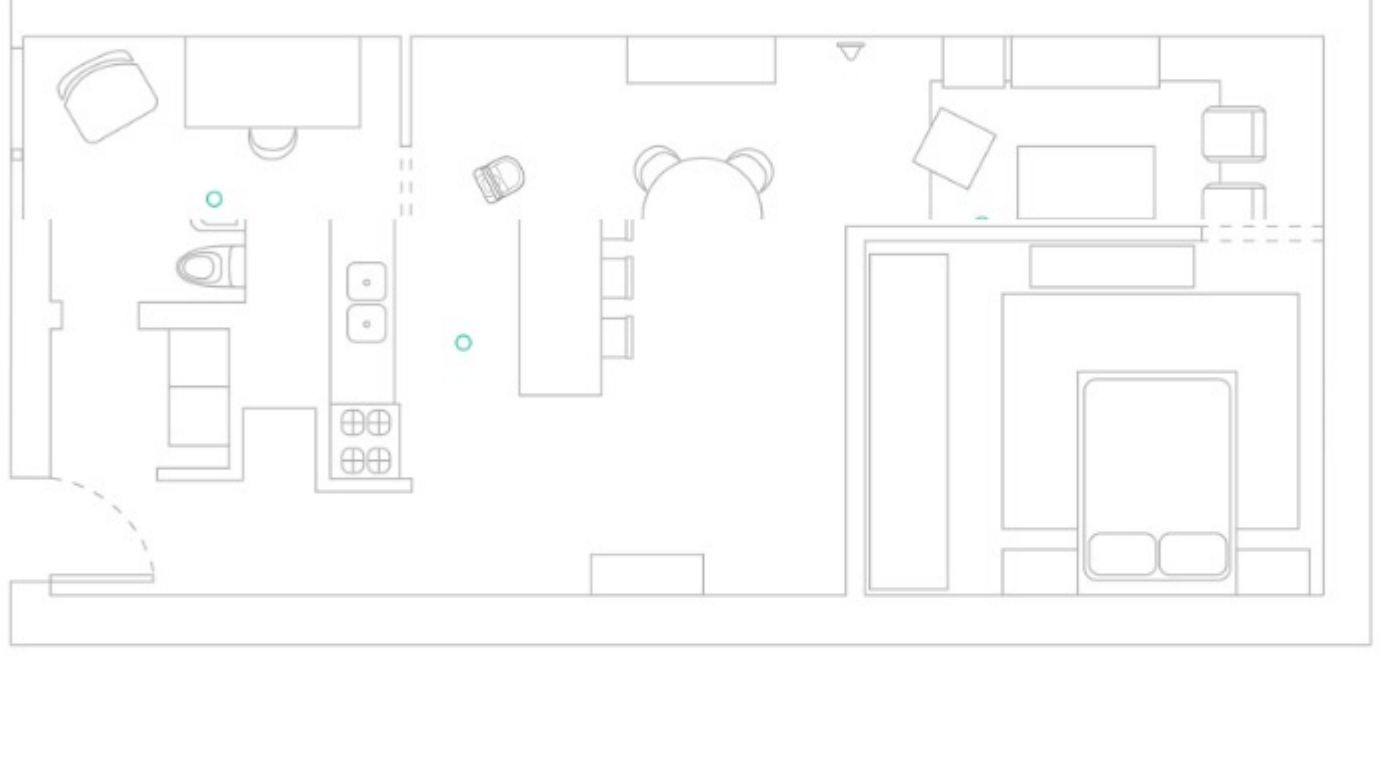

TEMI OS

Super intuitive operating system that comes, hears, speaks, sees and understands you, and is always learning how to serve you better

Temi center – Online management system for centralized control and customization
<https://center.robotemi.com/>

VOICE INTERACTION
 temi hears, identifies, understands and responds to the user's voice using Auto Speech Recognition (ASR) and far field voice technology, natural language processing (NLP), speech-to-text and text-to-speech (TTS) engines

USER INTERFACE
 temi's designed display enhances your experience with visuals that invite you to speak, hear and see what you want – creating the ultimate human-robot interaction

AI
 temi integrates the best AI engines together to connect you to your favorite services. It's navigation system self-learns it's surroundings and understands where temi is, what it is seeing and where it is going.

Facial recognition supported
 Open to 3rd party apps
 Full SDK Available for 3rd party apps development and deployment

SECURITY
 Top security measures and protocols.
 Protected by Firedome IOT security.



BUILT IN APPS

Built in and Temi Designated App Store, with Apps available from global developers

- AI Assistant
- Sound System
- SDK
- Navigation System
- Video Calls & Cameras
- User Experience

CONNECTIVITY

WIFI
 WIFI 5 (802.11 a/b/g/n/ac with both 2.4G/5G)

BLUETOOTH
 V5.1 BLE compatible Master and slave modes

USB
 1 USB 3.0 port TYPE-C, 1 USB 2.0 port TYPE-A Supports 4G USB dongle
 Supports external USB camera
 Supports common USB devices

CELLULAR (OPTIONAL)
 Cellular network SIM slot 4G/5G support

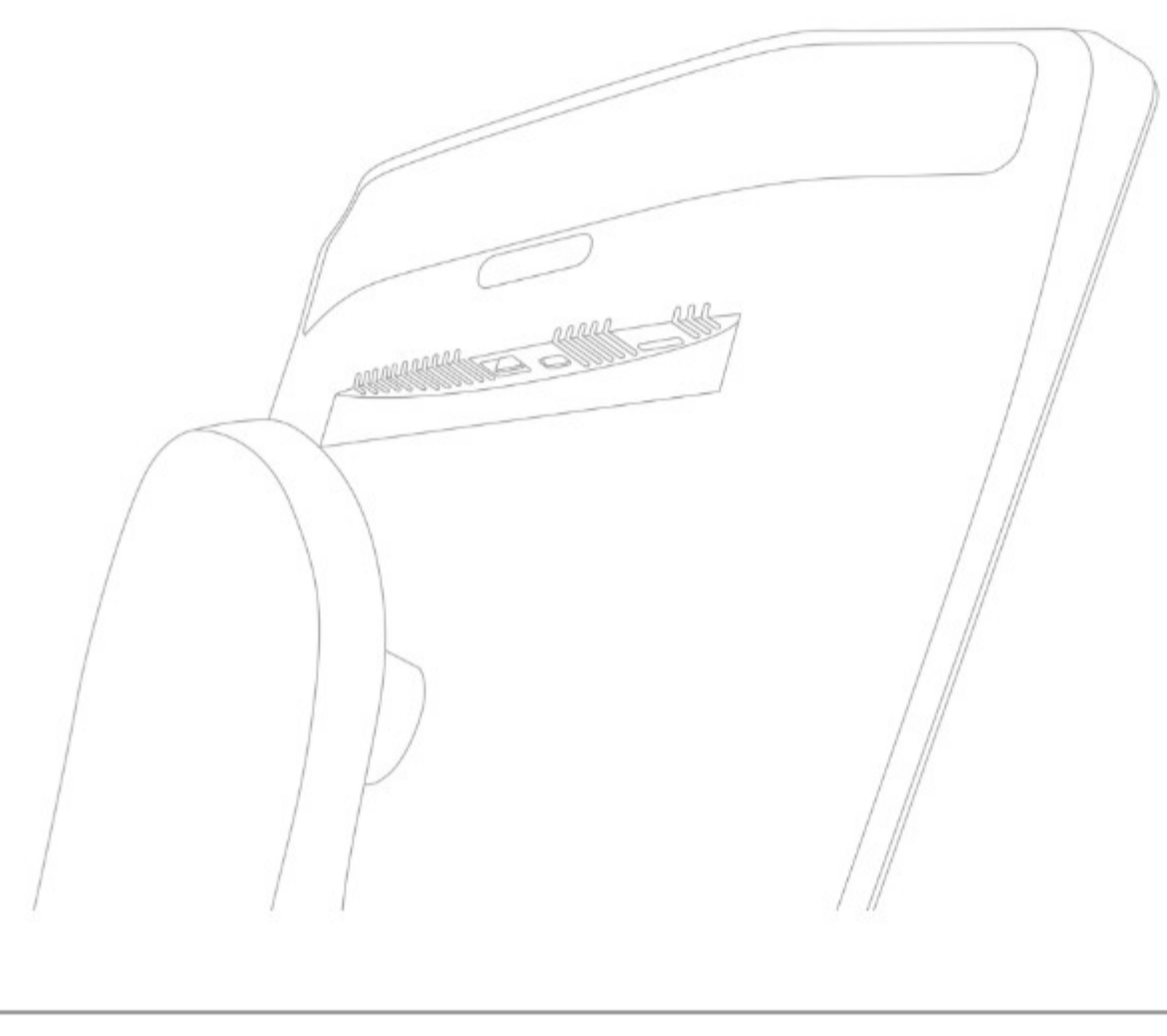

DIMENSIONS

SIZE
 (ft.) 3.2H x 1.1W x 1.5D
 (cm.) 100H x 35W x 45D

WEIGHT
 26 lbs / 12 kg

DISPLAY

13.3" (H293.76 / V 165.24)
 Capacitive multi-touch for intuitive interface. (1920X1080) IPS LCD 16M colors Touch Capacity Display Pixel density: 224 (ppi)

340 cd/m2 max brightness (typical)
 Fingerprint-resistant coating



SCREEN TILT

Autonomous face tracking screen tilt
 Brushless DC motor with planetary gear for high accuracy and quiet operation
 Motion range – 15°+/-+55°

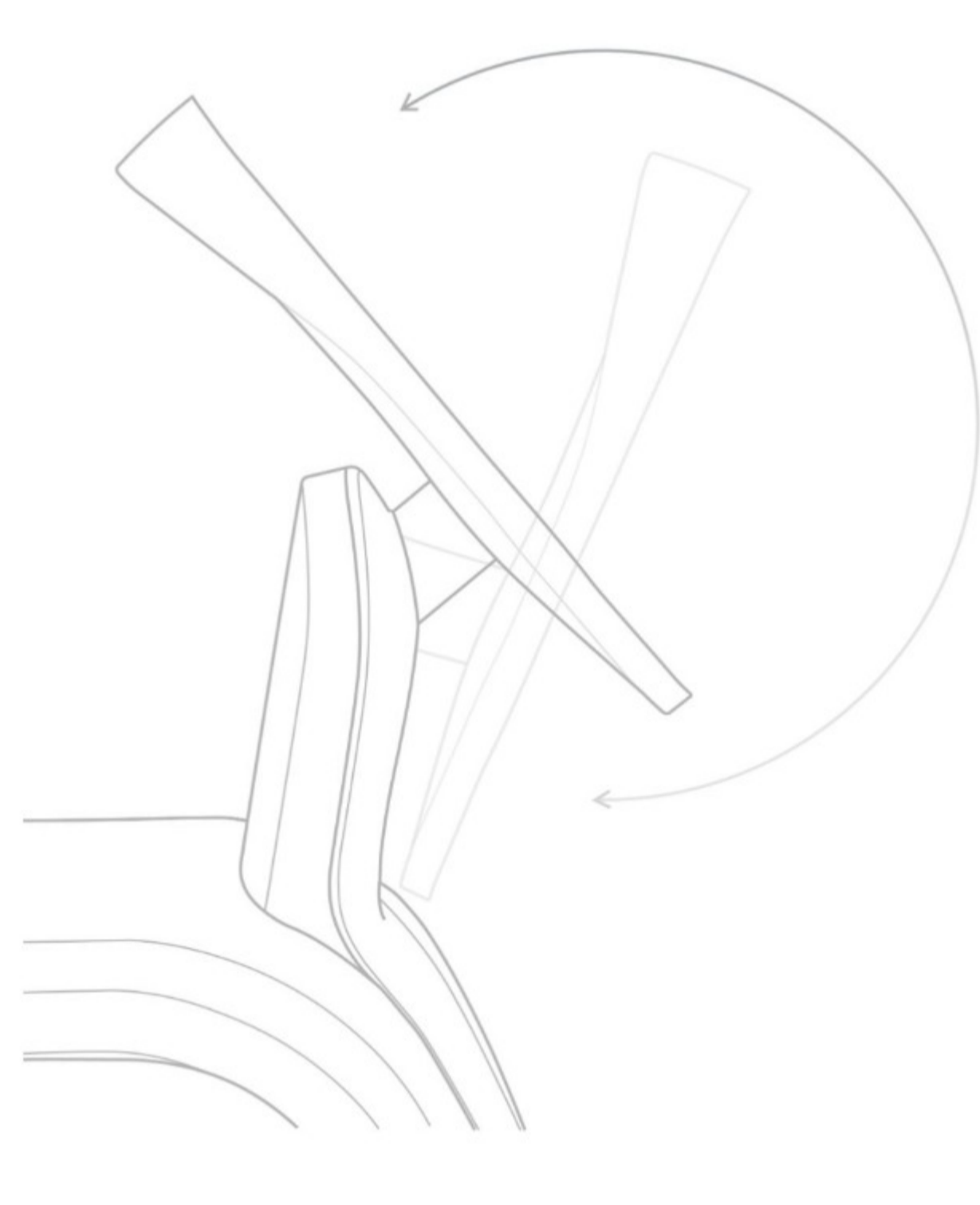

MICS

MICROPHONE ARRAY
 4 Omni-directional digital mics
 Real-time localization
 Beam forming
 Acoustic echo cancellation
 Environment noise reduction

AUDIO

20W Audio
 High fidelity equalizer
 One sub-woofer
 Two midrange speakers
 Two tweeters
 Passive radiators
 Acoustically transparent fabric

CAMERAS

13 MP HIGH RESOLUTION CAMERA
 Autofocus
 1080p@30FPS
 FOV 120 Degrees
 5-Element lens
 Hybrid IR filter
 Digital Zoom

TOF DEPTH CAMERA
 30 FPS
 Up to 5 meters
 90° FOV

CPU

CPU 1
 Dual-core Cortex-A72 1.8GHz
 Quad-core Cortex-A53 1.4GHz

OPERATION SYSTEM
 Human interaction computer based on Android 11 architecture with proprietary launcher and User Interface

CPU 2
 Dual-core Cortex-A72 1.8GHz
 Quad-core Cortex-A53 1.4GHz

Main navigation computer based on ARM architecture, enabling high performance with minimal power consumption

POWER

Up to 8 Hours of operation per charge
 Autonomous charging- 220V/110V
 High performance docking station
 Lithium-Ion cells

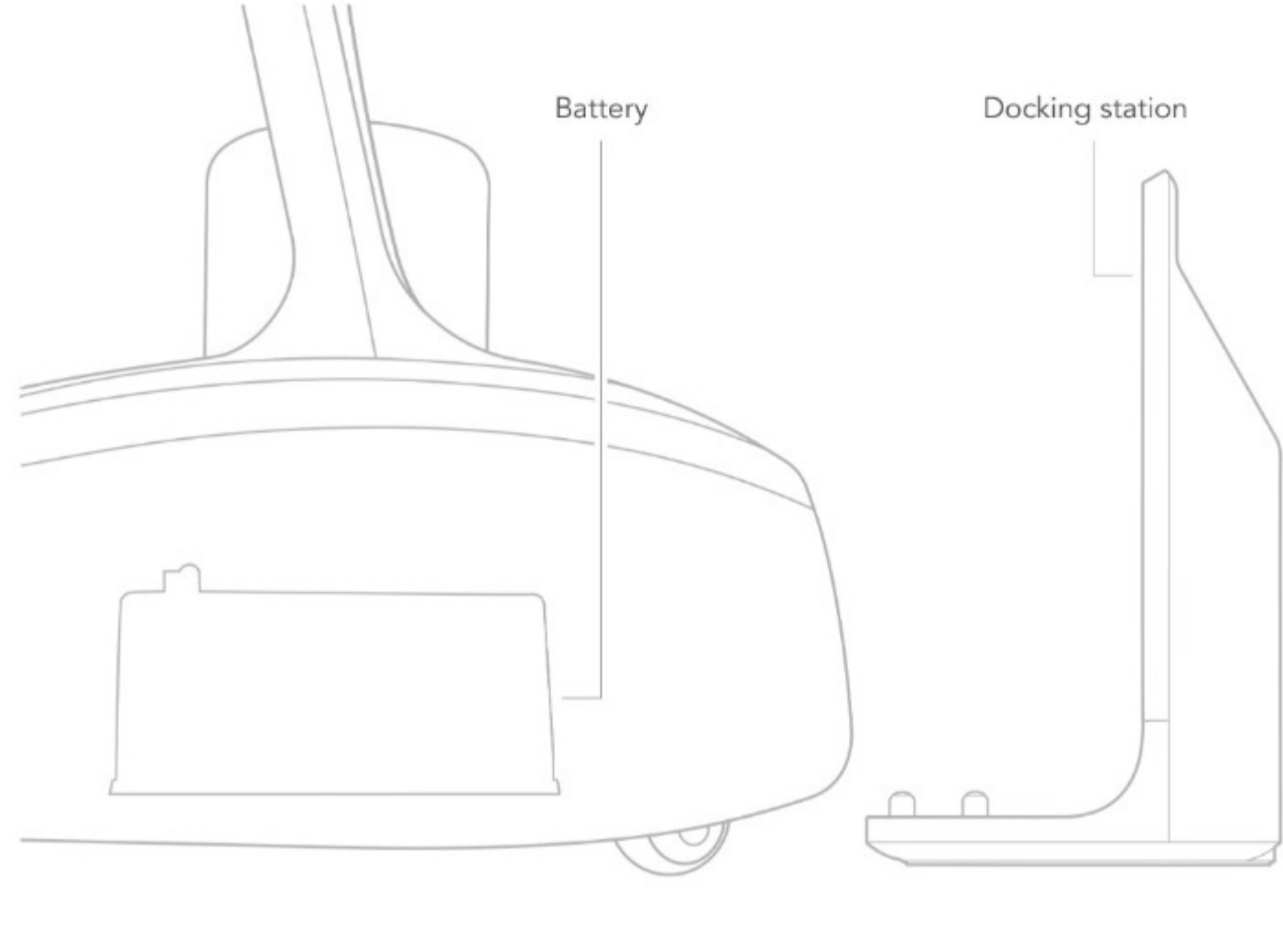

MOBILITY

Two independent 50 W direct drive Brushless DC motors
 High resolution magnetic encoders that produce a smooth, accurate ride

MANEUVERABILITY
 Zero turn radius

SPEED
 Up to 1 meter per second

Custom tires for optimal grip, stability and vibrations management

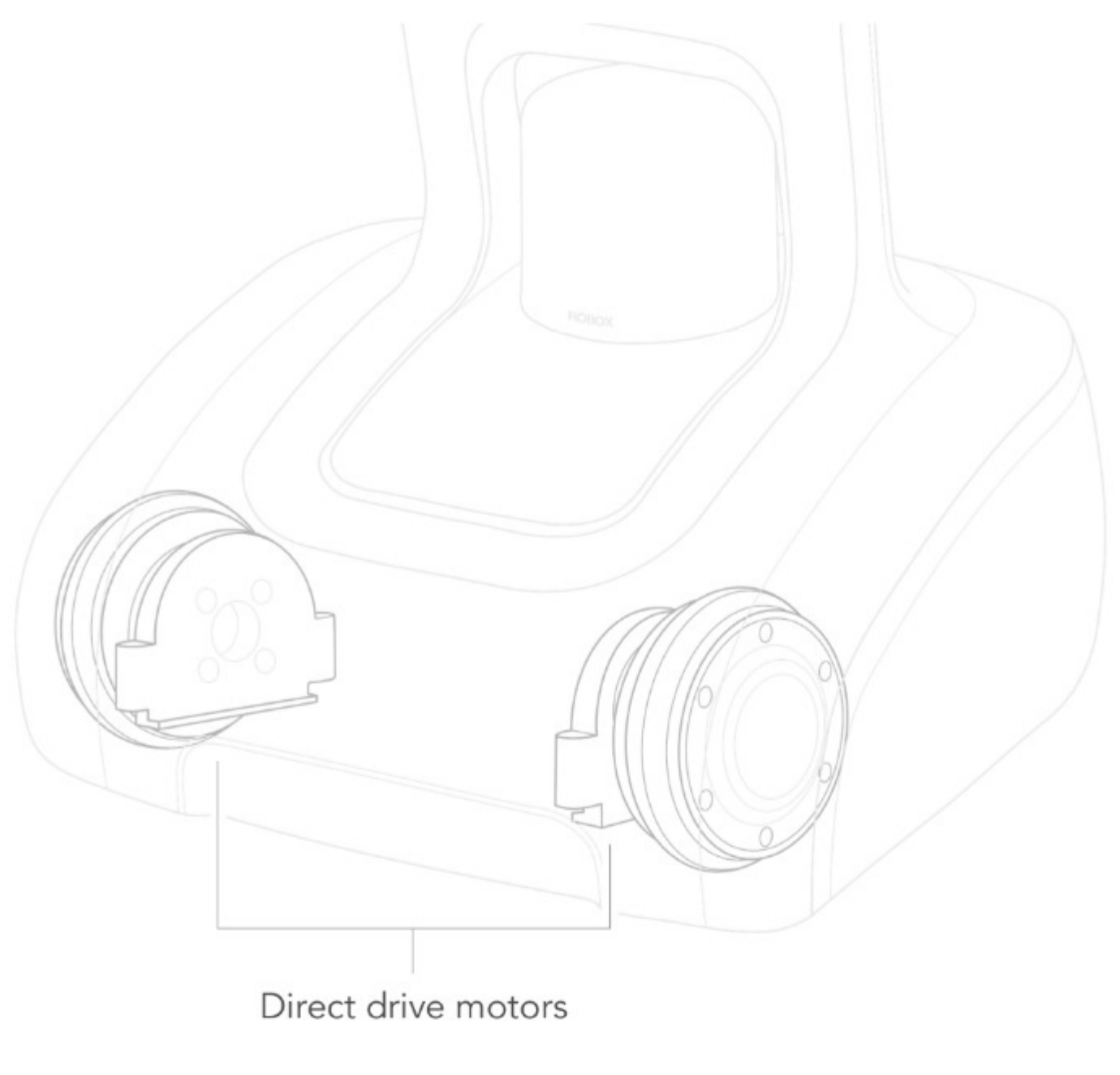

TRAY

ERGONOMIC TRAY
 temi V2 or V2 upgraded to V3:
 The tray contains a standard wireless charger for your mobile phone
 temi V3:
 The tray contains a 12V DC power jack and 4 screw holes for add-on attachment.

0.98ft X 0.8ft/ 30cmx25cm
 Tray load: 6.6Lb / 3KG (Depends on assembly – consult with support team)

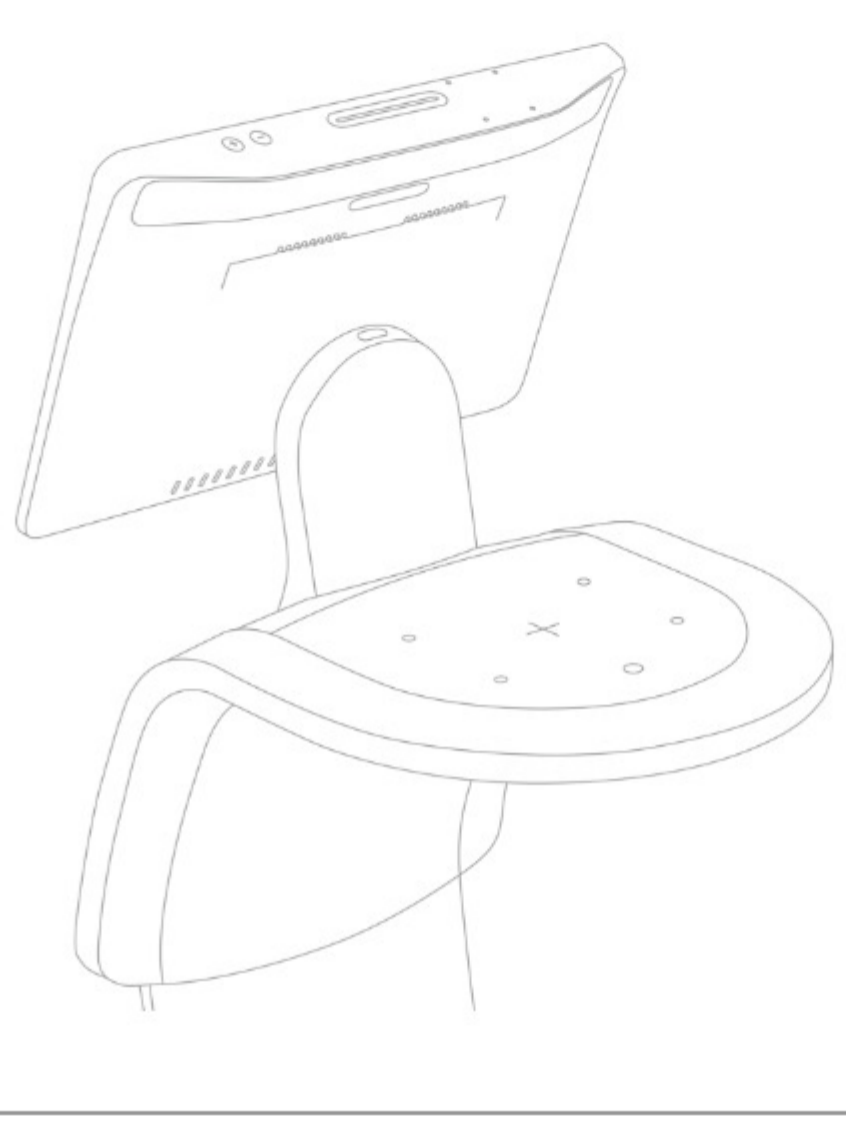

IN THE BOX

- 1 temi robot
- 1 Docking station+ Cable
- Quick setup guide